

THE PROJECT

The arts at Spelman College include Art, Drama and Dance, and Music. There has been a long-term need for more space for these departments and space that is contiguous and appropriate to support the academic program. Administrative and support space for the College’s Museum of Fine Art has been another, related need. In 2004, DOBER LIDSKY MATHEY (DLM) was asked to help the College develop a facility program for a new arts center.

CHALLENGE

Over many years the only options for increasing arts space at Spelman had been to add to or replace the existing building. Site constraints limit the former option and the latter was not feasible, as the arts program could not operate during demolition and reconstruction. Another challenge was the need for administrative and support space for the Museum of Fine Art, located in the Cosby Academic Center, a building that would be extremely difficult to expand.

SOLUTION

With acquisition of land adjacent to the Spelman campus, building a new arts facility became possible. The challenge at this point was to match program size to a feasible budget. This was achieved through numerous meetings and with input from administrators and user groups. The new Center will be 92,000 net assignable square feet and will provide almost three times the amount of space that currently exists.

The project will also contain Museum of Fine Art support space, permanent collections storage, and a conservation lab. Renovation of underutilized space in the Cosby Center to better support the Museum will also be part of the project.

RESULTS

Fund raising is now under way, an architect has been selected, and the design process has begun.

*Project completed under previous name: Dober, Lidsky, Craig and Associates, Inc.

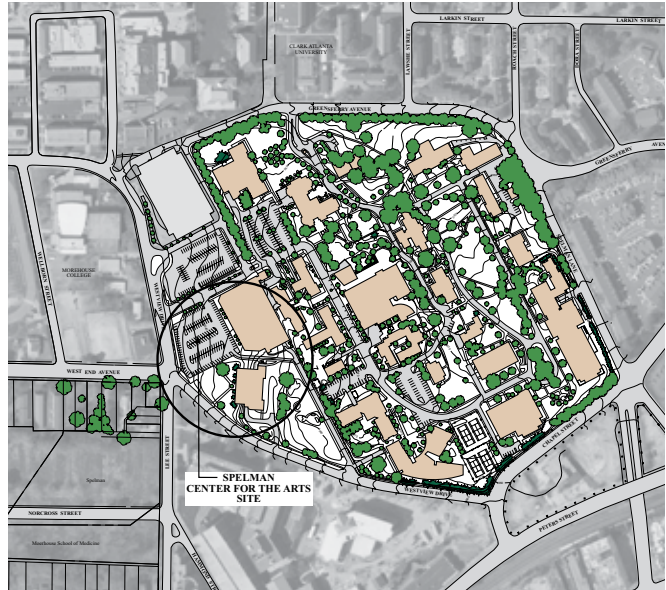

SITE LOCATION DIAGRAM

REFERENCE

Arthur E. Frazier III
Director, Facilities Management and Services
404 270 5436
AEFrazier@spelman.edu

PRINCIPAL IN-CHARGE

Arthur J. Lidsky, AICP, FAAAS
Study Director



DOBER LIDSKY MATHEY
CREATING CAMPUS SOLUTIONS