

THE PROJECT

As part of a long-term improvement plan, St. Lawrence University constructed a new Student Center to replace the existing Noble Center. DOBER LIDSKY MATHEY (DLM) was retained to help the University determine how vacated space in Noble could be reused. Departments under study — Fine Arts, Music, and Speech and Theater — were located in Griffiths Arts Center, attached to Noble, as well as in two small buildings on campus. The goal was to consolidate and expand space for the arts, and the Brush Gallery, which is also in this complex.

CHALLENGE

The challenge was to meet the facility needs of the fine and performing arts and the gallery in the Griffiths-Noble complex within a limited budget. This required planning for a minimum amount of major reconstruction in the renovation of existing space and little to no new construction.

SOLUTION

Through a highly participatory process, DLM prepared a facility program for the arts and for the Brush Gallery. Based on the program, a reuse plan was developed, which specified the level of renovation that would be required by area. From this, a phased strategy for improvements was determined.

RESULTS

Phase I was completed in January, 2005 and Phase II was completed in May, 2007. Phase III improvements are expected to be done in the fall of 2009.

*Project completed under previous name: Dober, Lidsky, Craig and Associates, Inc.



GRIFFITHS ART CENTER



NOBLE CENTER

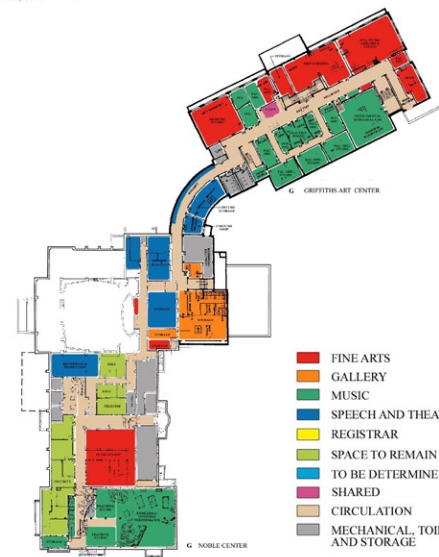

NOBLE REALLOCATION SCHEME

REFERENCE

Dr. Thomas Greene
Psychology Professor
315 229 5115
tgreene@stlawu.edu

PRINCIPAL IN-CHARGE

Arthur J. Lidsky, AICP
Study Director

George G. Mathey, AICP
Study Co-Director



DOBER LIDSKY MATHEY
CREATING CAMPUS SOLUTIONS